

THIS DRAWING AND ALL INFORMATION CONTAINED HEREIN IS THE PROPERTY OF WELDON TECHNOLOGIES, INC. AND MAY NOT BE COPIED, REPRODUCED, OR DEVLGED TO UNAUTHORIZED PERSONS WITHOUT THE EXPRESS WRITTEN CONSENT OF WELDON TECHNOLOGIES, INC. AS IT IS BEING PROVIDED SOLELY FOR THE CONVENIENCE OF THE USER AND SHALL BE RETURNED TO WELDON TECHNOLOGIES, INC UPON REQUEST.

REVISIONS				
REV.	ECN	DESCRIPTION	DATE	BY APVD
A	R0444	RELEASE DOCUMENTATION	9/9/03	TS ST

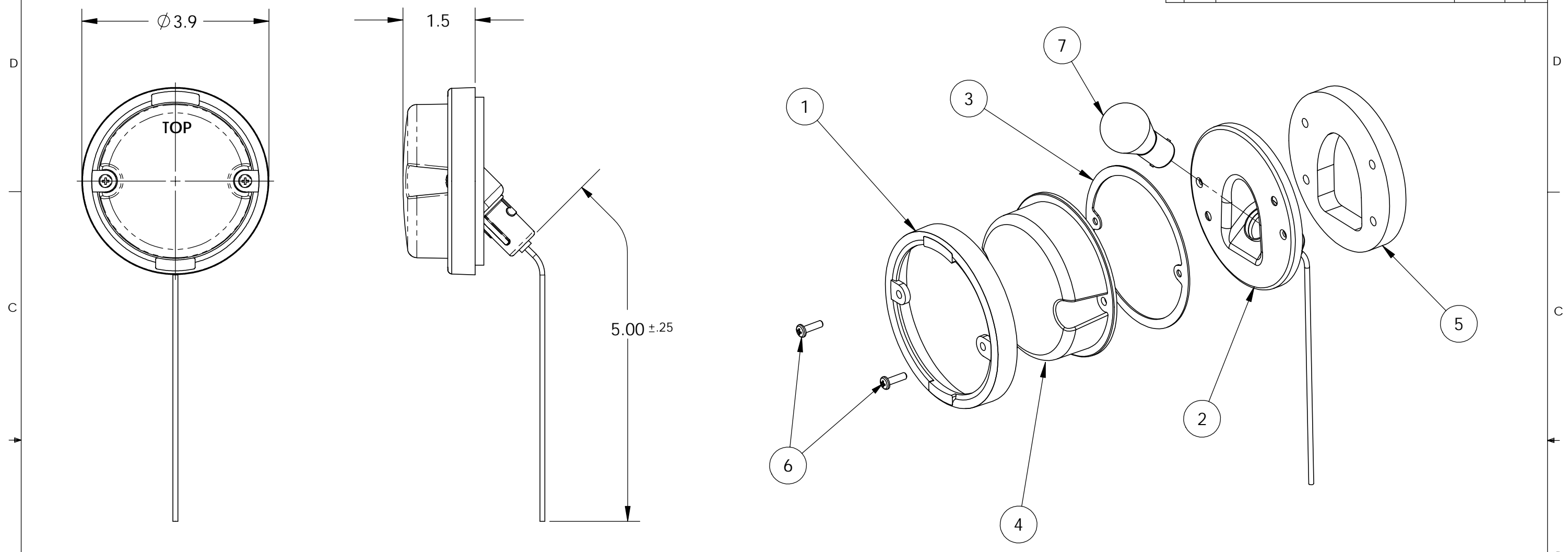

ITEM NO.	QTY.	DESCRIPTION
1	1	Bezel, Black, General Purpose Polycarbonate
2	1	Lamp Body / Socket Assembly: -Socket: Mild Stl. Zinc plt'd w/yellow chromate conversion -Body: CRS Zinc plt'd w/ clear chromate conversion -Wire: Black, 18ga. GXL (length & strip as indicated)
3	1	Gasket, Lens, Vulcanized fiber, .04 (1mm) Thk.
4	1	Lens, Clear Polycarbonate, GE Lexan LS2 or Approved Equivalent
5	1	Gasket, Mounting, Black Closed Cell Foam Rubber, 10mm
6	2	Screw, #6-32 x 1/2" lg. Double Recessed Pan Hd. Stainless
7	1	Bulb, #1156, 32cp, 12V, 2.10 Amps

- NOTES:
1. THIS LAMP ASSEMBLY IS TO COMPLY WITH APPLICABLE SECTIONS OF FMVSS108, AND ANY STANDARDS REFERENCED THEREIN WITH RESPECT TO BACK-UP LAMPS, PER SAE J593c FEB 68.
 2. THE LAMPS ARE TO BE SHIPPED WITHOUT THE LENS SCREWS INSTALLED. THE LENS SCREWS SHOULD BE BAGGED SEPARATELY AND PLACED IN THE MASTER CARTON.
 3. THE LAMPS ARE CELL DIVIDED AND PACKED 100 LAMPS (5 LAYERS OF 20) PER MASTER CARTON.
 4. DRAWING VIEWS ARE FOR PICTORAL REFERENCE ONLY. ACTUAL PRODUCT MAY VARY SLIGHTLY FROM THE DEPICTIONS.

UNLESS OTHERWISE SPECIFIED DIMENSIONS ARE IN INCHES TOLERANCES ARE: X.XXX - ±0.005 X.XX - ±0.020 X.X - ±0.050 ANGLES - ±0.5°	CAD GENERATED DRAWING. DO NOT MANUALLY UPDATE		WELDON TECHNOLOGIES, INC.	
	APPROVALS	DATE		
	DRAWN	TS 6/11/03	CUSTOMER DRAWING BACKUP LAMP, 3" BLACK BEZEL, SINGLE WIRE	
	CHECKED	ST 8/22/03		
MATERIAL	QUAL ENG	SIZE PART NO. B C9186-4570-30		
FINISH	MFG ENG	REV. A		
DO NOT SCALE DRAWING	PROJ. NO.	SCALE: 1:1	WELDON COMPUTER GRAPHICS SHEET 1 OF 1	